

# PRISON

## MUTANT

niveau 1

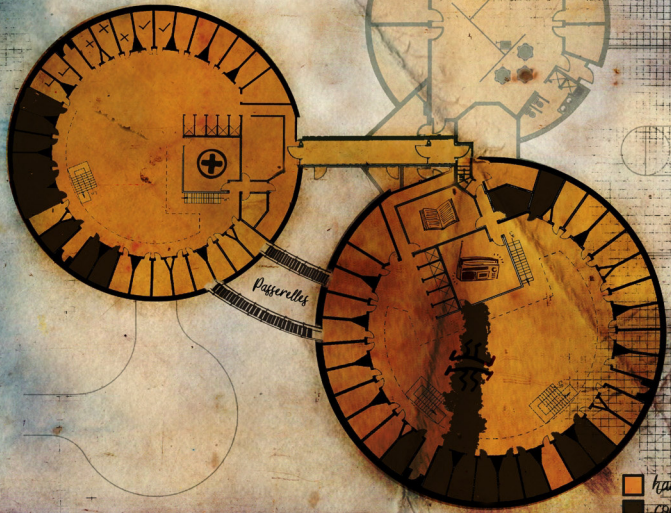

■ habitable  
■ condamnée

# PRISON MUTANT

niveau 0

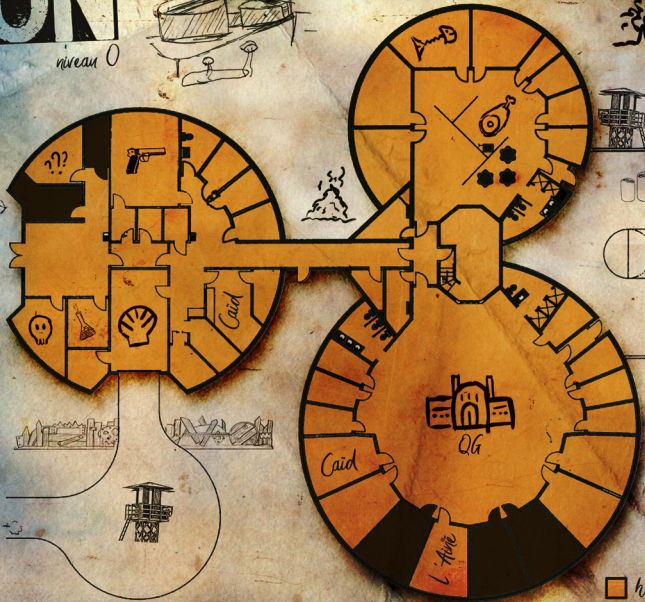

■ habitable  
■ condamnée

# PRISON

## MUTANT

niveau 1

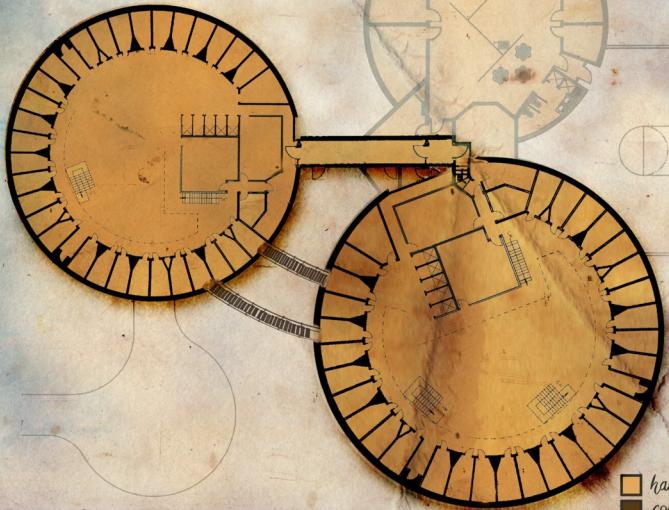

■ habitable  
■ condamné



# PRISON

## MUTANT

niveau 0

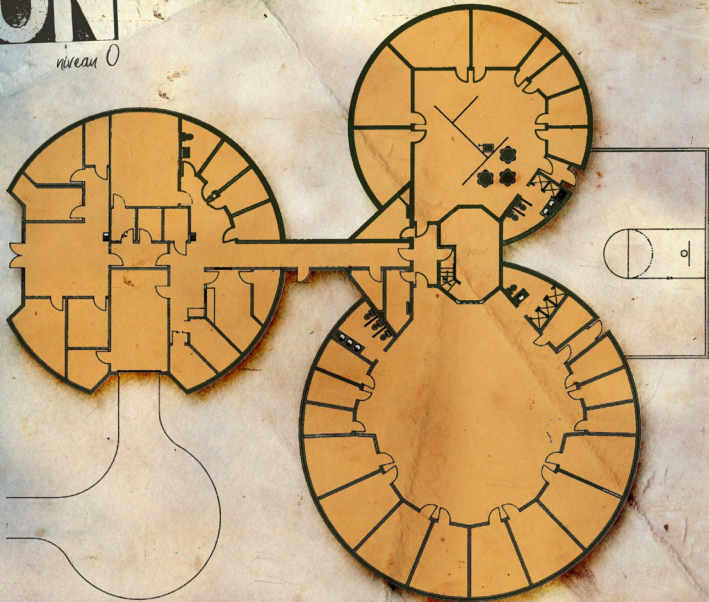



# PRISON

MUTANT  
YEAR ZERO

niveau 1

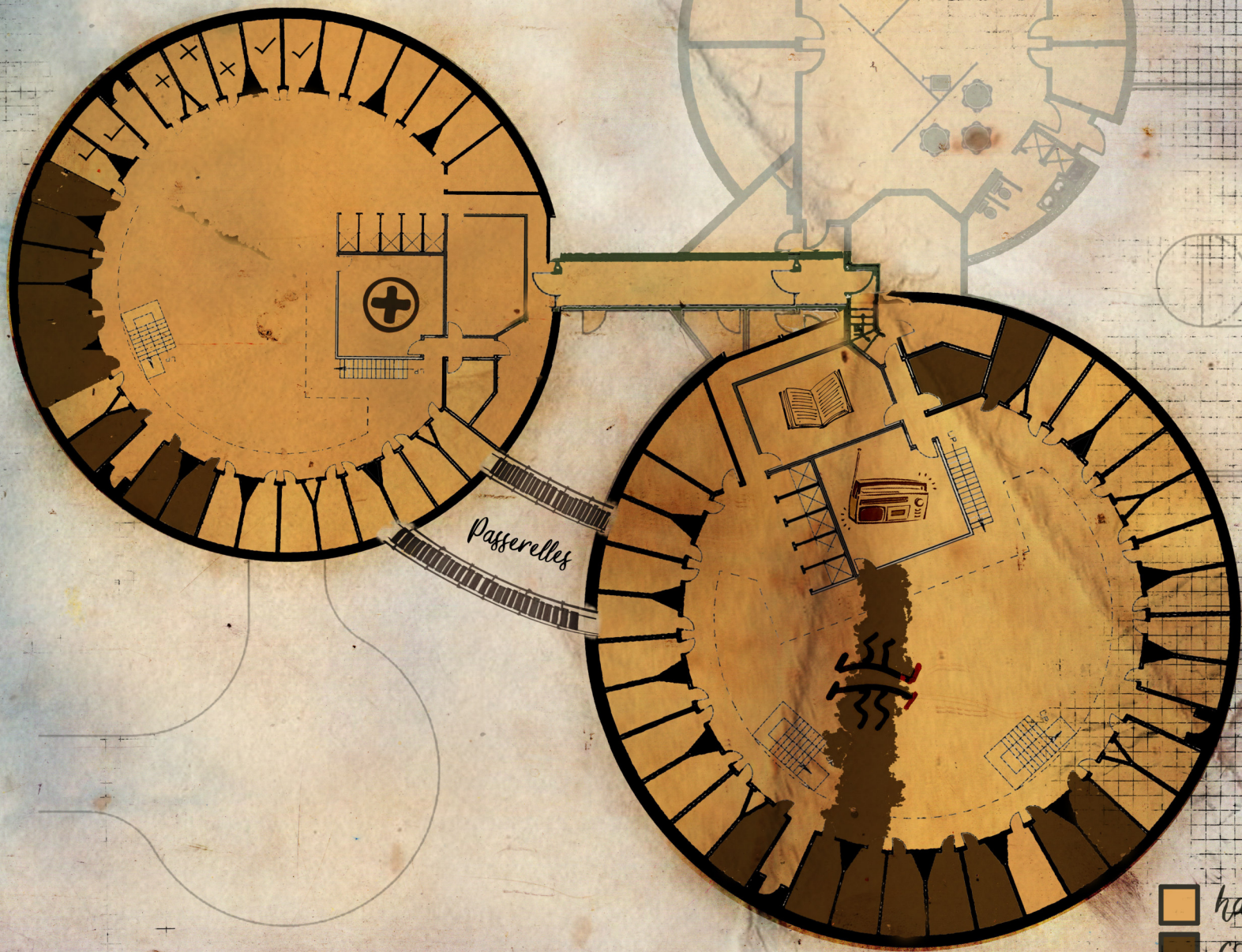



# PRISON

## MUTANT

YEAR ZERO

niveau 0

La maison

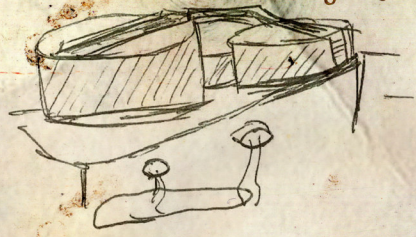

Eau

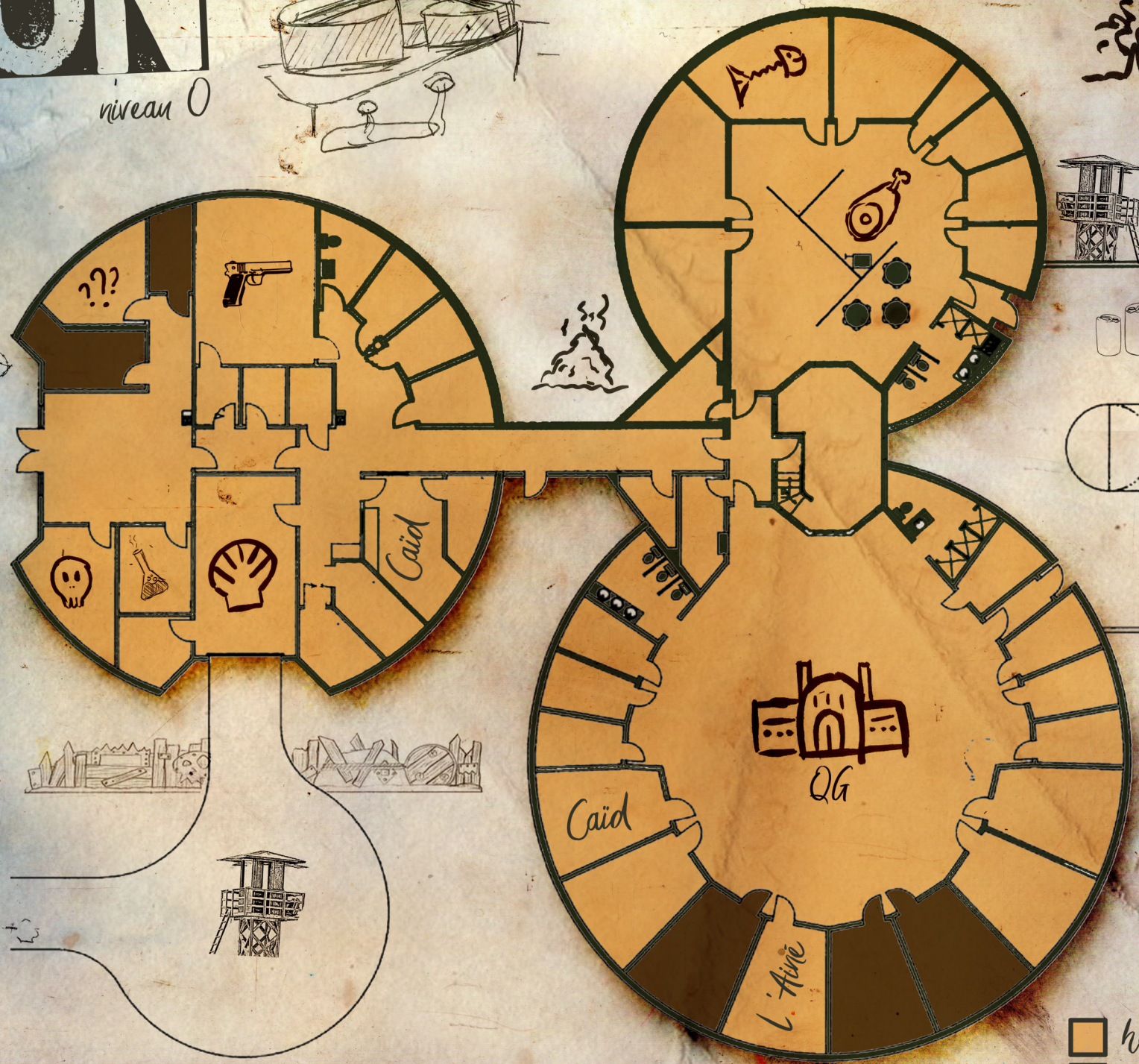
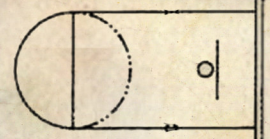
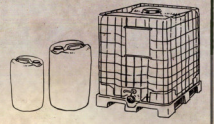

Expédition

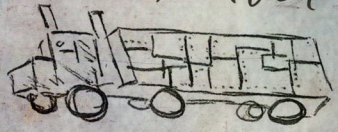

surtout pas la nuit

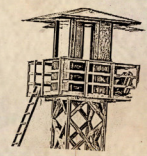

habitable  
condamné